

November 2023



ARBORISTNOW
URBAN FORESTRY



News from the Urban Forest

Step into November with our latest newsletter edition! Stay updated and in the loop – don't miss out on this month's harvest of autumn insights and updates.

[Visit Our Website](#)

Project Highlight

In the picturesque locale of El Cerrito, CA, our team has been diligently

focusing on structural pruning, a technique essential for the health and vitality of our urban forests. This meticulous process is not just about aesthetics; it's about ensuring that understory plants receive adequate light. By carefully pruning and shaping the canopy, we can increase light penetration, allowing these understory species to thrive. This balance between the towering trees and the plants below is crucial for a harmonious and healthy ecosystem. Join us in appreciating the nuanced art of structural [pruning](#) and the brighter, more vibrant understory it nurtures.



Reimagining Urban Spaces: *Custom Millwork Sustainable Landscaping*

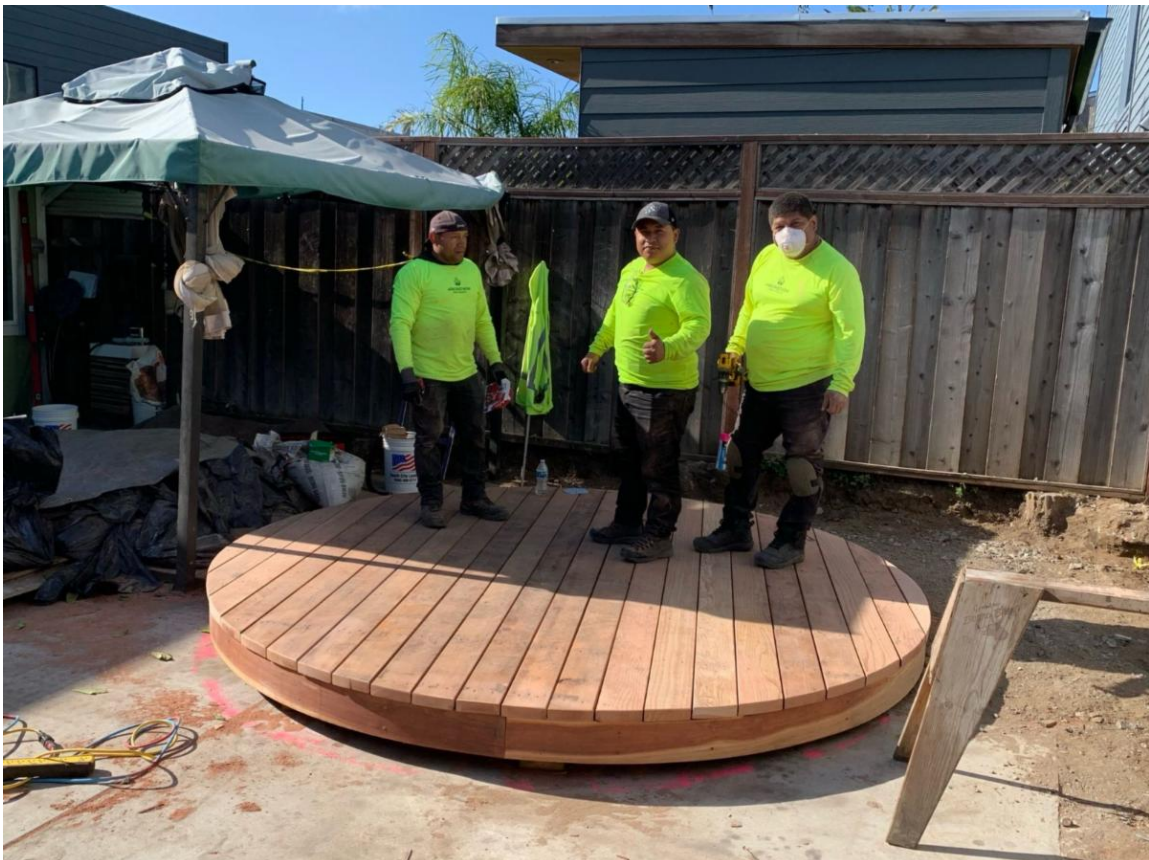

Love to be sharing this project update with our wonderful community of

green thumbs and nature lovers!

We're thrilled to share with you a behind-the-scenes peek into one of our most recent projects. We've had the honor of collaborating with the Low Income Investment Fund (LIIFund) and the [Scientific Art Studio](#) on an eco-friendly initiative that truly embodies our commitment to sustainable practices.

In the accompanying photo series, you'll witness the birth of a unique planter box, crafted lovingly from reclaimed Eucalyptus wood. This wood was carefully milled by our skilled team into 5" x 8" cants, then painstakingly arranged in a sequence that mirrors the natural, flowing beauty of nature.

But we didn't stop there! To further enhance the organic aesthetic, we've sculpted and carved the individual pieces. The result? A planter that is not just a container for plants, but a work of art that pays homage to the elegant and organic forms found in nature itself.

We hope these images inspire you as much as the project has inspired us. Remember, every small step towards sustainability counts, and together, we can make a big difference. Stay tuned for more updates on our exciting projects!



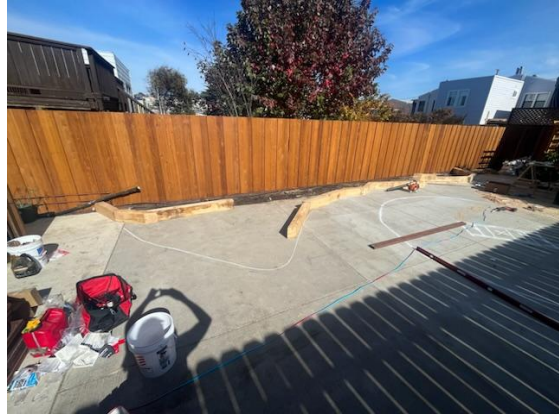

Our [landscape design](#) team have begun using milled wood slabs for benches. They are using using milled redwood and eucalyptus cants(square, rectangular wood) in our gardens as steps, retaining walls, and planter edges. Beautiful!

Logs have been turned into stumps - debarked, sanded with beveled edges for path borders, sand box enclosures, seating and climbing structures. The possibilities are endless!



[Contact](#) our landscaping and milling team for help with your outdoor and sustainable visions!

Arborist Now Blog

Have you checked out our [blog](#) lately? It is full of tree, landscaping, and milling information. We're introducing guest writers and updating a long list of prior posts. If there's something you're like to read in our blog, let us know!

Don't miss, [*Why Your Arborvitae is Turning Brown and How to Fix It.*](#)



Tree Quiz: Festive Foliage & Thanksgiving Timber

1. Which tree is often dubbed the "wishbone" of the forest because of its association with Thanksgiving and its historical importance to Native Americans and early settlers?

- a. Oak
- b. Maple
- c. Pine
- d. Birch

2. Which tree is famous for its vibrant red and orange leaves during the fall season, making it a favorite for autumn enthusiasts?

- a. Willow
- b. Redwood
- c. Maple
- d. Pine

3. Which fruit, often associated with traditional Thanksgiving dishes, is a favorite treat during the fall but doesn't actually grow on trees?

- a. Apple
- b. Cherry
- c. Cranberry
- d. Pear

4. The first Thanksgiving feast between the Pilgrims and the Wampanoag tribe in 1621 likely saw which tree's wood used for fire and construction?

- a. Pine
- b. Cedar
- c. Oak
- d. Birch

5. Which tree, often seen as a symbol of strength and endurance, is also considered a tree of gratitude, making it a perfect emblem for Thanksgiving reflections?

- a. Oak
- b. Redwood
- c. Willow
- d. Spruce

Trivia Rules

The **first 3** people to email the correct answers to each of these questions wins! The first place winner will receive a **\$200 voucher for any tree service!** Second and third place winners will receive a **\$100 voucher for any tree service!**

*Past FIRST place winners may play for fun; however, only one FIRST place win per person in a 12 month period. 2nd and 3rd runners up may try again in hopes of achieving first place status; however, they may only win one \$100 voucher per 12 month period.

Please email your answers to news@arboristnow.com with "**Quiz Answers**" in the subject line.

October Winners

1st - Max E.

Good luck!

OCTOBER QUIZ/ANSWERS

1. In Tim Burton's "The Nightmare Before Christmas," what holiday-themed doors are found in trees in the Halloweentown forest?

- d. Christmas and Easter

2. In the movie "Poltergeist," what becomes a terrifying entity during a storm?

- b. An old oak tree

3. In "Sleepy Hollow," directed by Tim Burton, Ichabod Crane often encounters the Headless Horseman near which type of tree?

b. Tulip Tree

4. In the TV show "Stranger Things," the Upside Down is accessed through a gap in which type of location?

c. A tree in the forest

5. In "Hocus Pocus," where do the Sanderson sisters live?

b. In a cottage near the woods

Joke of the Month



Why did the tree stop in November?

It wanted to autumn-atically drop its leaves! ☐

Tree Planting Time



Project highlight: *Planting 24" box Pinus canariensis and 15gal Juniperus chinensis for Laguna Heights HOA reforestation project in replacement of ailing Pinus radiata.*



November is the perfect time for tree planting. As the Bay Area anticipates the arrival of the rainy season, we at Arborist Now want to shed light on a golden opportunity: [tree planting](#). Why is the onset of the rainy season the ideal time to introduce new trees to your landscape? Let's delve into the reasons:

Cooler Temperatures: The mild chill of late fall is a boon for newly planted trees. Without the intense heat of summer, these young additions are less prone to heat stress and excessive water loss, allowing them to transition into their new

environment with ease.

2. **Consistent Rainfall:** Anyone familiar with the Bay Area knows that late fall and winter bring more predictable rains. This natural watering schedule ensures the soil remains moist, providing a nurturing environment for trees to grow and thrive.
3. **Root Renaissance:** Planting during these cooler months offers trees a head start. Before the hustle and bustle of the growing season,

roots have the chance to establish themselves, ensuring a strong foundation for the tree's future growth.

4. **The Beauty of Dormancy:** For deciduous trees, this period is a special one. As they enter dormancy, their focus shifts from leaf and branch growth to strengthening their roots. Planting them during this phase aligns with their natural rhythm, promoting healthier, more robust growth in the long run.

The upcoming rainy season is more than just a precursor to winter; it's a window of opportunity for your landscape. Whether you're looking to add shade, beauty, or simply diversify your green space, Arborist Now is here to guide and assist. Let's make the most of this season together! [Contact us today](#) for all your tree and landscaping needs.

4TH ANNUAL ARBORETUM DAY

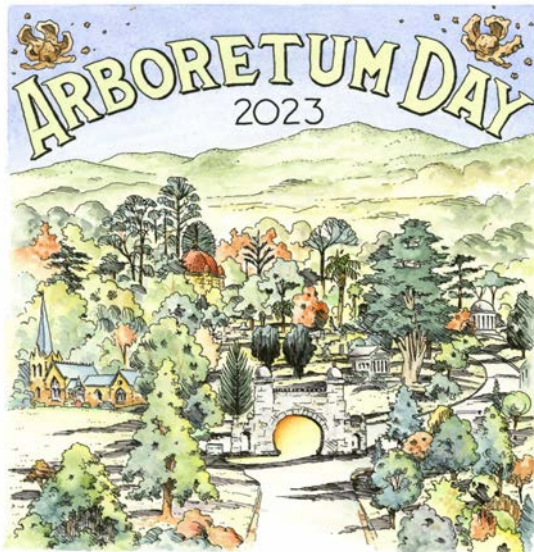

Illustration Credit: Chip Sullivan

Enjoy a day of tree education (and celebration!) of our diverse living collection of plants, 131 years in growing and ever branching out.

Location: East Campus of Cypress Lawn Arboretum | 1363 El Camino Real, Colma, CA 94014

Date & Time: November 18 @ 11:00 AM – 3:00 PM

Get all the great details [here!](#)

We Appreciate *YOUR* Feedback

Tell us how we're doing!



John B

4 reviews · 1 photo



★★★★★ a week ago

NEW

Positive: Professionalism, Punctuality, Quality, Responsiveness, Value

George came out for the initial consultation. Very nice and easy to communicate with. He knows a lot about the trees, and gave me some valuable tips.

There was only one tree that needed work. His crew came out within about a week and did a really nice job. They removed just the right amount to not stress the tree too much, but also not too little. It was encroaching onto the neighbor's property, and risked being too top-heavy.

Overall I'm very happy and will call them next time I need work on some of my larger trees.

Service: Tree trimming & pruning



Your reviews are vital in helping us enhance our services. We appreciate your feedback about your experience with us. Please consider leaving a review using the provided links. Thank you for your valuable input!

[Yelp](#)

[Google Reviews](#)

Your review is crucial to helping us serve you better (and you can earn \$100!). Please take a moment to share your valuable feedback using the links below. Thank you for your contribution to our continuous improvement efforts.

[Client Referral Program](#)

From the Field

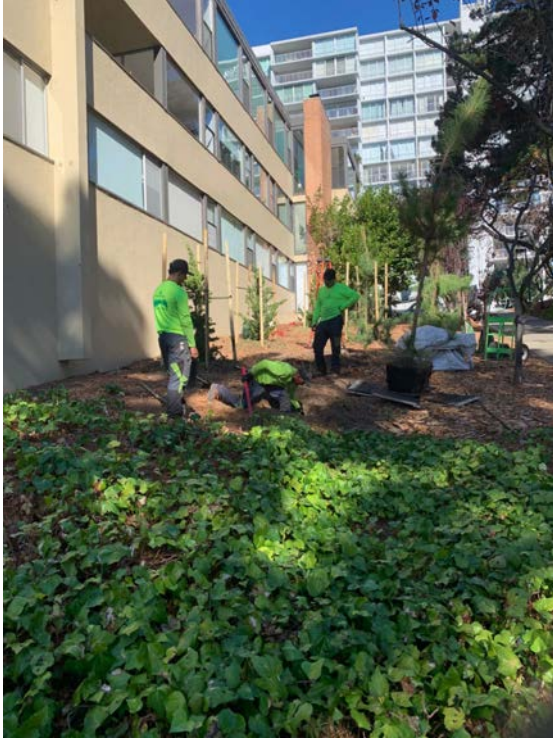



Thank *you* for being part of the **Arborist**

Now family! We appreciate *you* very much!

Arborist Now, Inc. | 415-310-7781 | news@arboristnow.com | arboristnow.com

STAY CONNECTED



Arborist Now, Inc. | 580 California Street, 12th Floor, San Francisco, CA 94104

[Unsubscribe elena@arboristnow.com](#)

[Update Profile](#) | [Constant Contact Data Notice](#)

Sent by news@arboristnow.com powered by



Try email marketing for free today!